

Tech Line Hits 1,000,000th Reference Number

November 1, 2001, marked a milestone event for Tech Line. They created their one millionth Tech Line reference number since opening for business on January 2, 1984. Tech Line answers 1.6 calls for each reference number they create. That comes out to approximately 1.6 million calls over the past 17 years. Well done, guys!

Auto Idle Stop Doesn't Work: '00-01 Insight

If an Insight customer complains that the Auto Idle Stop function *doesn't* work, follow these guidelines to fix the problem:

- Turn the heater control panel completely off.
NOTE: If the outside air temperature is 41° F or lower, the Auto Idle Stop function *doesn't* work with the panel turned on.
- Make sure the IMA battery is fully charged.
- Make sure the engine coolant is at normal operating temperature.
- Make sure there are no IMA, ECM, or transmission DTCs set. Also, make sure there are no DTCs set in the heater control panel.
- On Insights with CVT, if the Auto Idle Stop parameters listed above are OK, do the start clutch calibration procedure (see page 14-96 of the 2001 Insight S/M Supplement, Second Edition).

NOTE: The Auto Idle Stop function works *only* when the shift lever position indicator on the gauge assembly reads **D**. It *doesn't* work when the indicator reads **R**, **S**, or **L**.

CD Changer Can Be Added to RES: '02 Odyssey

Can a CD changer be added to an '02 Odyssey with the Rear Entertainment System (RES)? The answer is yes. The Honda Dealer Installed Options flipchart states you can't, but the chart is wrong.

I~VES Replacement Parts Available: '99-01 Odyssey

Honda parts stock now has replacement parts for the In-Vehicle Entertainment System (I~VES) accessory for '99-01 Odysseys. Refer to this chart when ordering:

NOTE: These parts do *not* fit the factory-installed Rear Entertainment System (RES).

Description	Part Number	Honda Code
Videocassette Player Console	08A60-S0X-1M050	6772081
Videocassette Player Assembly	08A60-S0X-1M001	6772040
Videocassette Player Bracket (R)	08A60-S0X-1M012	6772065
Videocassette Player Bracket (L)	08A60-S0X-1M014	6772073
Videocassette Player Owner's Manual	08A60-S0X-10081	6772057
Videocassette Player Headset	08A60-S0X-1M005	6772115
Overhead Monitor	08A60-S0X-1M055	6772099
Videocassette Player Remote Control	08A60-S0X-1M006	6772107
Wire Harness	08A60-S0X-10030	6772131
Hardware Kit	08A60-S0X-100R1	6772123

Starter Auto-Start and Anti-Grind: '02 Passport

The '02 Passport has two new starting system features that are PCM-controlled.

Auto-Start

After the ignition switch is held in the START position for more than 1 second, the PCM takes control of the starter motor and keeps it engaged until the engine starts. If you release the ignition switch from the START position *before* the engine starts, the PCM cranks the starter motor for 5 seconds or until the engine starts. To see how this feature works, push the accelerator pedal all the way to the floor and hold it there (fuel flood clearout mode). Turn the ignition switch to START for more than 1 second, then release the switch.

Anti-Grind

The PCM keeps the starter motor from engaging while the engine is running and disengages it as soon as the engine starts.

PGM Tester Software SN201 Has New EVAP System Test

In last month's *ServiceNews*, we told you about a new evaporative system function test included in the latest PGM Tester software version SN201 (see the article "New Software for PGM Tester: SN201" in the November '01 issue). This test, listed in the PGM-FI menu under "Inspection," determines if the EVAP system has a leak. Here's some more info on this test:

- Use this test to determine what caused the DTC. Run it *before* doing any repair work. You may want to run this test several times to detect intermittent solenoid function.
- Use this test *after* completing repairs to make sure the repair was effective. Run it *before* returning the vehicle to your customer.
- This test applies to '98–01 Accords, '98–01 Civics, '98–01 CR-Vs, and '99–01 Odysseys.
- The evaporative system function test for other models will be added in future PGM Tester software releases.

If you have any questions about loading the CD, call the HondaNet Support Center at **1-800-245-4343**.

DTC P0705 After Long Crank Time: '98–99 Passport

On '98–99 Passports, if the MIL comes on and DTC P0705 (mode switch illegal position) is set, ask your customer if the MIL came on after a long crank time (more than 5 seconds). If so, and it was caused by a lack of fuel, reset the PCM and return the vehicle to your customer. If the long crank time was caused by another problem, fix that problem first before trying to troubleshoot DTC P0705. This DTC sets after cranking the engine for more than 5 seconds. Here's the reason:

- When the ignition switch is in the ON position, 12 volts are supplied to Fuse No. 14 in the dash fuse box, which supplies 12 volts to the A/T gear position switch.
- When the ignition switch is turned to the START position, there's no voltage supplied to Fuse No. 14. As a result, the A/T gear position switch can't send a gear position signal to the PCM.
- If the PCM doesn't get a signal from the gear position switch for more than 5 seconds, the PCM sets DTC P0705.

This info came to us from **Michael Malloy** of Lindell Honda, Tampa, FL. Thanks, Michael.

Rear Bumper Paint Peeling: '01 Civic 2-Door

Some '01 Civic 2-door models may have paint peeling on the horizontal surface of the rear bumper under the taillights. S/B 01-076, *Rear Bumper Paint Is Peeling*, filed under Body, was recently issued to fix this problem. The repair adds foam blocks to the bottom lip of each taillight lens.

A factory countermeasure was recently applied that adds two ribs on the horizontal surface of the bumper under each taillight so the taillight doesn't hit the bumper. The countermeasured bumper shares the same part number as the original bumper, so there's a mix of non-countermeasured and countermeasured bumpers in Honda parts stock. However, if you happen to install the foam blocks on a vehicle with a countermeasured bumper, it's *not* a problem.

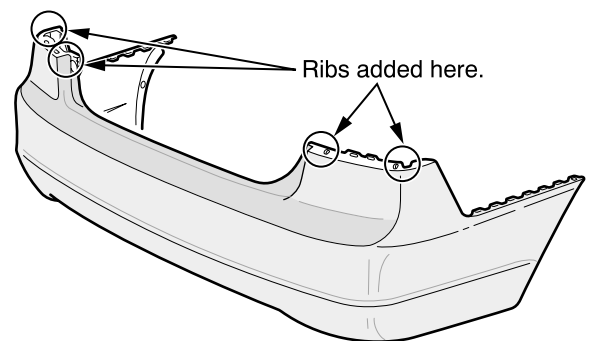

Defog Mode Keeps A/C On

On '01–02 Civics, '02 S2000s, '02 Odyssey LXs, and '02 CR-Vs, when you select Defog mode, the system automatically switches to Fresh Air mode and turns on the A/C compressor. This is to clear fogged windows quickly by blowing fresh, dehumidified air from the defroster vents at the base of the windshield.

While in Defog mode, the A/C stays on and *can't* be turned off. After you switch from Defog mode to another mode, the A/C stays on until you turn it off.

Immobi Light Blinks After Start-up: '02 CR-V

On '02 CR-Vs, a timing problem in the ECM/PCM software can cause the immobilizer indicator light to begin blinking right after the engine starts. To reset the immobilizer system, turn the ignition switch to LOCK (0), and restart the engine. The factory is developing a HIM Program I.D. to fix this problem. It will be available in January '02.

Look for Fuses in Glove Box at PDI: '02 Odyssey

If you're doing a PDI on a '02 Odyssey with a VIN of 2HKRL1...2H521180 or higher, don't bother looking in the center pocket for the fuses that were removed for shipping. Even though it says so in S/B 01-067, *2002 Odyssey: PDI and New Model Information*, filed under PDI, you'll find the fuses stored in the glove box on vehicles above that VIN.

Add New VIN Range to S/B 00-036: '00 Passport

Change your copies of S/B 00-036, *Product Update: 2000 Passport Rear Suspension*, filed under Suspension, to include this additional VIN range in the "Applies To:" box at the top of the bulletin:

From VIN 4S6C.58..Y4400001 thru 4S6C.58..Y4410635

Revise S/B 99-076: '98-99 Passport

The rear speed sensor subharness that's installed to eliminate connector C304 in S/B 99-076, *ABS Indicator Light Is On With ABS DTCs C0235, C0236, or C0237*, filed under Brakes, has been changed. The subharness that comes in the latest kit has different colored wires. This poses a problem since you can't match the subharness wires with the wire harness as needed in step 10 of the repair procedure.

To ensure proper installation, change step 10 of the repair procedure to read: "Using the smallest setting on the crimper tool, attach the BLK wire of the subharness to the joint connector on the BLK wire of the wire harness. Connect the remaining wires of the subharness to the remaining joint connectors on the wire harness."

Multiple SRS DTCs After Dashboard Replacement

On '01-02 Civics and '00-02 Accords, if multiple SRS DTCs are setting after removing or replacing the dashboard or center console, check the SRS connectors where the dashboard joins the center console. If these connectors are cross-connected, the SRS control unit sets SRS DTCs. To fix this problem, refer to the appropriate S/M and ETM, and make the proper connections.

Headrest Rattles on Bumpy Roads

If your customer complains that the headrest rattles when driving on bumpy roads, the headrest support rails may need adjusting. Remove the headrest, and spread the support legs so they press outward against the headrest guide.

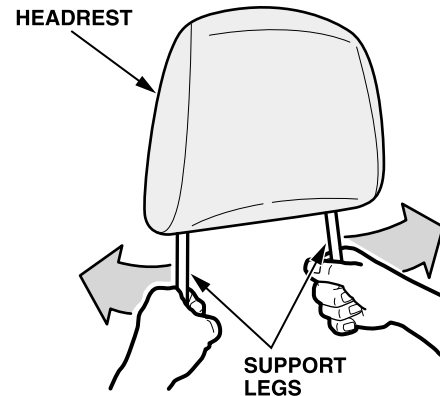

Front Windows Won't Fully Roll Down: '01-02 Civic

On '01-02 Japan-built Civics, if the driver or front passenger window won't go down all the way, the problem may be loose side impact energy-absorbing foam blocks. If a foam block comes loose from the door panel, it can obstruct the door glass movement. To fix this problem, remove the door panel and look at the foam blocks. If a block is loose, reinstall it with a glue gun using Bostic 6329 polyimide hot melt glue. If you can't get Bostic products locally, call either of these Bostic representatives:

Bostic Sales: Jim Bucaro, **847-459-3210**

Bostic Distribution: Mike Naseef, **513-574-3211**

Axle Pops or Creaks: '00-02 S2000

On '00-02 S2000s, if your customer complains of hearing a single pop or creak from the rear of the vehicle when changing direction from forward to backward and vice versa, the problem may be axle (driveshaft) movement in the rear hub. To eliminate the noise, replace the spindle nut on the affected axle. Apply grease to the surface of the new spindle nut where it contacts the hub. Torque the new nut to 298 N-m (220 lb-ft), and stake the nut.

Operating Tips for Honda CD Player and CD Changer

Here are some handy tips to keep in mind when using a Honda CD player or CD changer:

- Play *only* standard round CDs. Odd-shaped CDs may jam the drive or cause other problems.
- To get the best results from a CD-R (recordable) disc, make sure you use a high-quality disc labeled for audio use. When burning a CD-R disc, you *must* close the session to use the disc in a CD player.
- *Don't* try playing a CD-R disc in the Rear Entertainment System (RES); it *won't* work.
- *Don't* try playing a CD-RW (recordable/rewritable) disc in a Honda CD player or CD changer; it too *won't* work.
- A new CD may have rough inner and outer edges. The small plastic pieces that cause this roughness can break off and fall on the recording surface of the disc. This can cause skipping or other problems. To avoid this, remove these pieces by rubbing the inner and outer edges of the disc with the side of a pencil or pen.

Faulty SRS Unit Causes SRS DTC 7-3: '01-02 Civic

On '01-02 Civics, a faulty SRS unit will cause SRS DTC 7-3 (internal failure of the SRS unit) to set and turn on the SRS indicator light. To fix the problem, replace the SRS unit (see page 23-140 of the 2001-02 Civic Service Manual).

NOTE: If the vehicle has side airbags, make sure you initialize the OPDS.

Add '02 M/Y to S/B 00-059: '98-02 Accord L4

You need to make a change to your copies of S/B 00-059, *Thump at Cold Start*, filed under Fuel and Emissions. Include '02 model year in the "Applies To:" box at the top of the bulletin. All '02 Accord L4 models are affected except DXs without cruise control.

S/M Fix: A/T Removal, '99-02 Odyssey

Step 28 on page 14-376 of the 1999-02 Odyssey Service Manual tells you to use an engine hanger (T/N 07XAA-001030A) to lift and support the engine during transmission removal. This hanger *doesn't* work on an '02 model. The '02 model has a higher intake manifold that requires a shorter cable eye/bolt assembly for the engine support hanger. Honda Special Tools recently shipped all dealers a cable eye/bolt assembly (T/N 07ZAA-S0XA100) for this purpose.

Mark up your copies of the S/M to look like this:

the special tools as shown.

28. Lift and support the engine with ~~an engine hanger (T/N 07XAA-001030A, available through the American Honda Tool and Equipment Program).~~ Position the tool over the hood latch. Loop the cable (A) around the throttle body (B), and tighten the wing nut (C) on the tool by hand until the cable is tight.

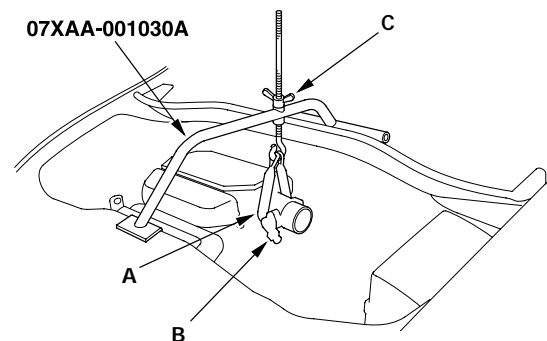

NOTE: For '02 model, replace the cable eye/bolt assembly (A) on the engine support hanger with T/N 07ZAA-S0XA100.

 **HONDA ServiceNews**

©2001 American Honda Motor Co., Inc. - All Rights Reserved. Published by AHM Service Communications, 1919 Torrance Blvd., Torrance, CA 90501-2746. All suggestions become the property of American Honda Motor Co., Inc.; sending a suggestion gives Honda permission to publish it without further consideration.

