



Reverse or 5th Gear Is Difficult to Select

SYMPTOM

Shifting into reverse or 5th gear is difficult.

PROBABLE CAUSE

Moisture in the shifter housing has caused the mechanical reverse lockout assembly to corrode and stick.

CORRECTIVE ACTION

Remove, clean, and lubricate the shift lever.

PARTS INFORMATION

Silicone Grease:

P/N 08798-9013, H/C 4642294
(One tube will repair about 50 vehicles.)

Urea Grease:

P/N 08798-9002, H/C 3720984
(One container will repair about 20 vehicles.)

WARRANTY CLAIM INFORMATION

In warranty: The normal warranty applies.

Operation Number: 212202

Flat Rate Time: 1.2 hours

Failed Part: P/N 54205-S2A-003
H/C 6238828

Defect Code: 030

Contention Code: B99

Template ID: 02-046A

Skill Level: Repair Technician

Out of warranty: Any repair performed after warranty expiration may be eligible for goodwill consideration by the District Parts and Service Manager or your Zone Office. You must request consideration, and get a decision, before starting work.

DIAGNOSIS

The reverse lockout may bind in either the up position or the down position, making reverse or 5th gear difficult to select.

- If reverse or 5th gear, but not both, are difficult to select, go to REPAIR PROCEDURE.
- If reverse and 5th gear are both difficult to select, troubleshoot other causes.

REPAIR PROCEDURE

1. Remove the center console. Refer to page 20-76 of the 2000-02 S2000 Service Manual.
2. To remove the boot holder (white ring), look for the arrowheads on the inside diameter of the holder; they indicate the locations of the retaining clips underneath. To release each clip, insert a hook tool under the arrowhead, and lift slightly while releasing the lock tab on the clip with a flat-tip screwdriver.

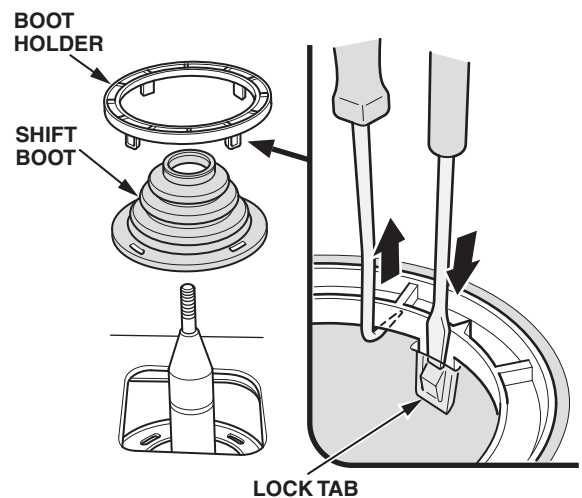

3. Pull up and remove the boot holder and the shift boot.

- Lift shift lever boot C, and remove the three bolts that secure the shift lever. Pull straight up to remove the shift lever and the spring.

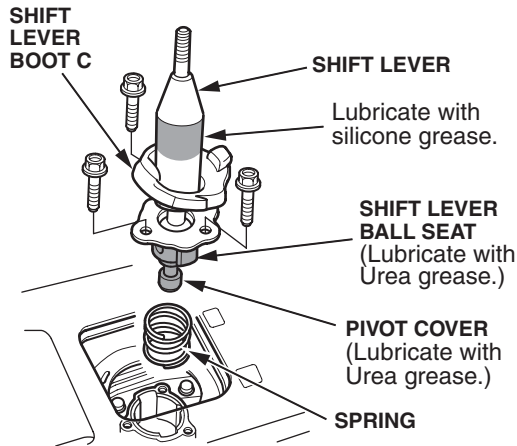

- Inspect the white plastic shift lever ball seat and the aluminum shift housing for moisture or corrosion.
- Thoroughly clean the ball seat and the aluminum housing with solvent.
- Lubricate the shift lever ball seat, the aluminum shift housing, and the pivot cover with Urea grease.
- Install the spring and shift lever assembly. Torque the three bolts to 10 N·m (7 lb-ft), and secure shift lever boot C.
- Lubricate the area where the shift boot contacts the shift lever with silicone grease.
- Align the slots of the shift boot with the lock tabs of the boot holder. Press the boot and holder into position.
- Reinstall the center console.
- Raise the vehicle on a hoist.

- Check the gasket that seals the shifter boot holder to the underside of the car.

- If the six tabs of the gasket are not seated properly and are not visible, go to step 14.
- If the six tabs of the gasket are seated properly and are visible, torque the shifter boot holder mounting bolts to 10 N·m (7 lb-ft), then go to step 17.

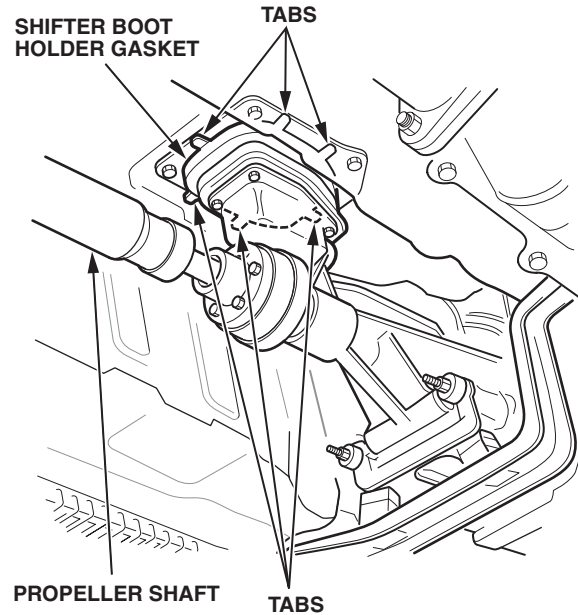

- Remove the four bolts from the shifter boot holder, and lower the holder.
- Reposition the gasket properly with the six tabs exposed.
- Install the shifter boot holder mounting bolts. Torque the bolts to 10 N·m (7 lb-ft).
- Lower the car.
- Check shifter operation by selecting reverse and 5th gear.