

RESET ECU

Step 1

While many folks prefer to simply disconnect the negative battery terminal, it's easier to just pull a fuse. Locate the backup 7.5a fuse, which is the third one down from the second column in your fuse box, and pull it out.

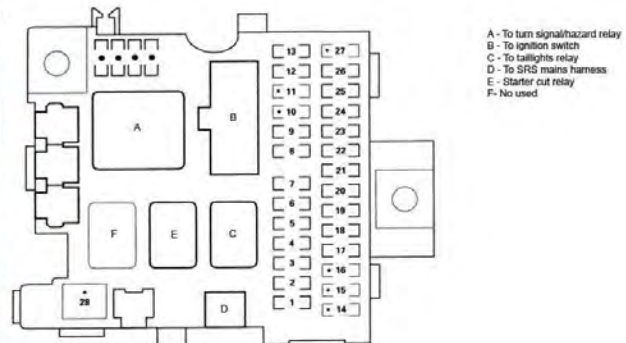

Fuses
Under-dash Fuse/Relay Box (cont'd)

Fuse No.	Amps	Wire colour	Component(s) or Circuit(s) Protected
1	10 A	GRN or PNK	SRS unit (VB)
2	15 A	GRN or BLK/YEL	SRS unit (VA)
2	15 A	BLK/YEL	Fuel pump, PGM-FI main relay
3	7.5 A	BLK/WHT	Engine start switch
4	15 A	BLK/YEL	Ignition coils
5	7.5 A	YEL	Back-up lights, EPS control unit, Gauge assembly, Keyless door lock control unit, Soft top control unit
6	15 A	BLK/YEL	Alternator, Charging system light, Cruise main switch indicator light (KH model), Cruise control unit (KH model), ELD unit, EVAP purge control solenoid valve, Headlights adjuster control unit (KG, KE and KQ models), Primary HO2S, Air control solenoid valve, Secondary HO2S
7	7.5 A	RED/BLU	Turn signal/hazard relay
8	20 A	GRN/BLK	No. 12 fuse (in the under-dash fuse/relay box), Headlight washer switch and control unit (KG, KE and KQ models), Intermittent wiper relay, Power window control unit (in the power window master switch), Windshield wiper motor.
9	10 A	WHT/RED	Accessory power outlet, Audio remote switch, Audio unit
10	-	-	Not used
11	-	-	Not used

Step 2

Wait 60 seconds before plugging the fuse back in. Be sure that you reinsert it the same way that it came out to prevent damaging anything.

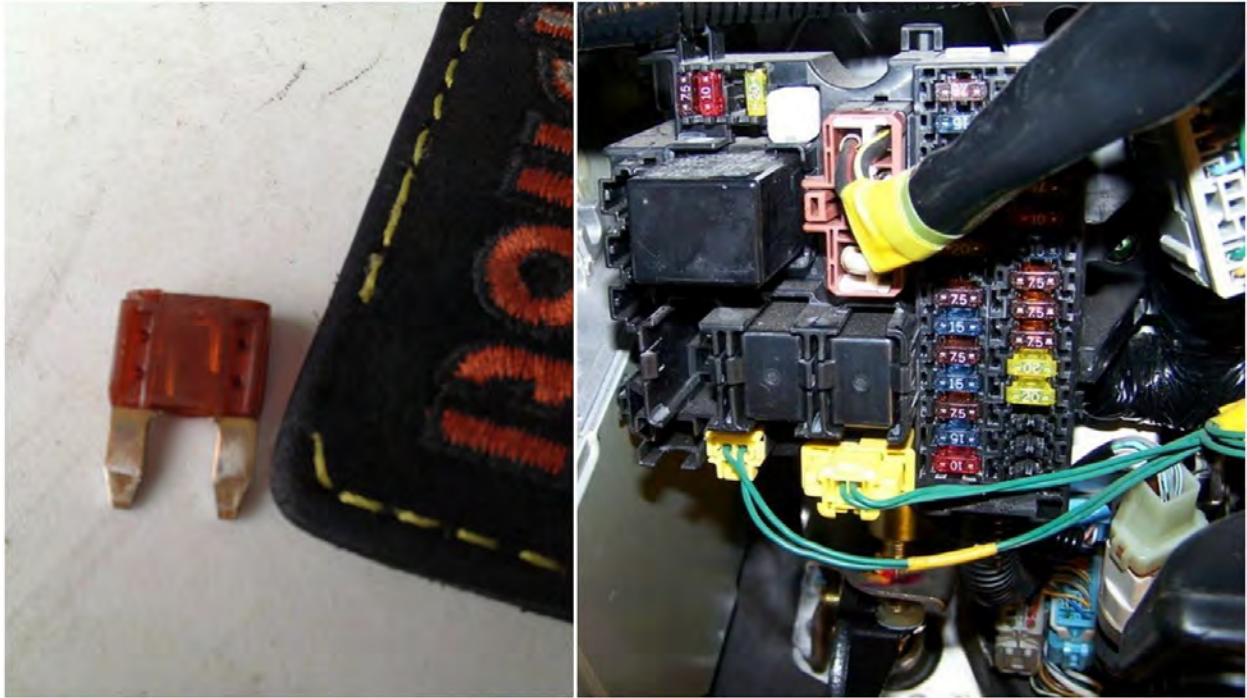

Step 3

Lastly, start your car and let it idle for a few minutes. This will allow the ECU to go through its idle learn process.