



INSTALLATION INSTRUCTIONS

Accessory HONDA MUSIC LINK	Application 2008 S2000 & S2000 CR	Publications No. All 38855
		Issue Date FEB 2008

PARTS LIST

Attachment Kit P/N:08A28-0J1-800

Adapter bracket A
(Not used)

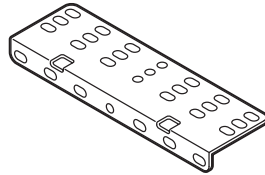

2 Adapter brackets B
(Not used)



Grommet



2 Screws, 4 x 10 mm
(Not used)



2 Bolts, 5 x 8 mm
(1 Not used)



2 Washer-screws, 5 x 16 mm
(Not used)



2 Flange bolts, 6 x 12 mm
(Not used)

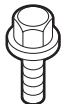

2 Flange nuts, 4 mm
(Not used)



2 Flange nuts, 5 mm
(Not used)



2 Flange nuts, 6 mm
(Not used)



4 Plain washers, 5 mm
(3 Not used)



2 Screw caps, 4 mm
(Not used)



2 Wire ties with clip
(Not used)

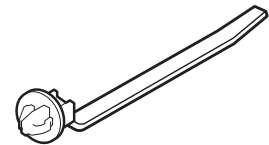

8 Wire ties
(3 Not used)

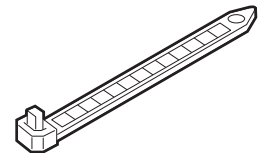

4 Urethane tapes
(Not used)

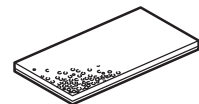

2 Cushion tapes
(1 Not used)

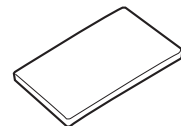

Honda Music Link Adapter Kit (sold separately)

P/N:08A28-1J1-100

Adapter unit

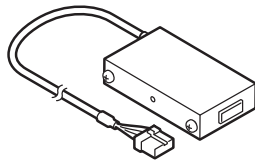

Music Link harness

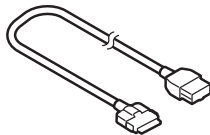

Accessory User's Information Manual

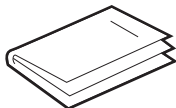

Bus Cable 2-Port (sold separately)

P/N:08A31-0F1-000

Bus Cable 2-Port

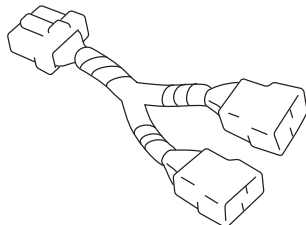

TOOLS AND SUPPLIES REQUIRED

Phillips screwdriver

Flat-tip screwdriver

Shop towel

Nippers

Ratchet

Utility knife

Isopropyl alcohol

Felt-tip pen

10 mm and 14 mm Spanner

Scale

File

Drill

3 mm Drill bit

16 mm Hole saw (Hole saw kit T/N: AKS 052507)

Pushpin

Clip remover

Masking tape

Eye protection (face shield, safety goggles, etc.)

Illustration of the Honda Music Link Installed on the Vehicle

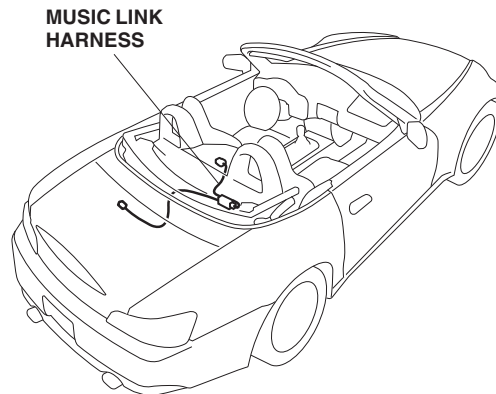

INSTALLATION

Customer Information: The information in this installation instruction is intended for use only by skilled technicians who have the proper tools, equipment, and training to correctly and safely add equipment to your vehicle. These procedures should not be attempted by "do-it-yourselfers."

1. Make sure you have the anti-theft code for the radio, then write down the radio station presets.

If the vehicle is CR model, go to step 9; otherwise, continue with step 2.

2. Close the soft top completely.

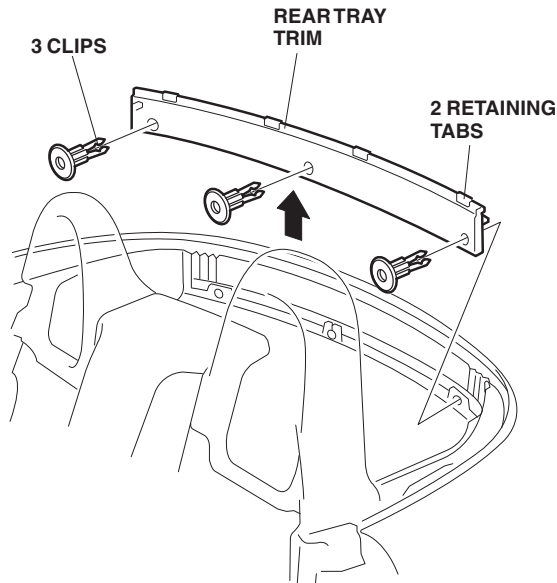

3. Remove the three clips from the rear tray trim. Remove the rear tray trim by releasing the two retaining tabs.
4. Remove the four front clips. Raise the rear tray to disengage the four rear clips.

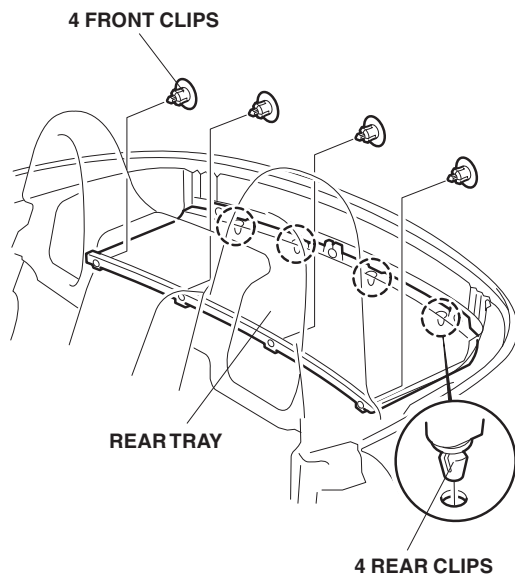

5. Open the soft top to an intermediate position as shown.

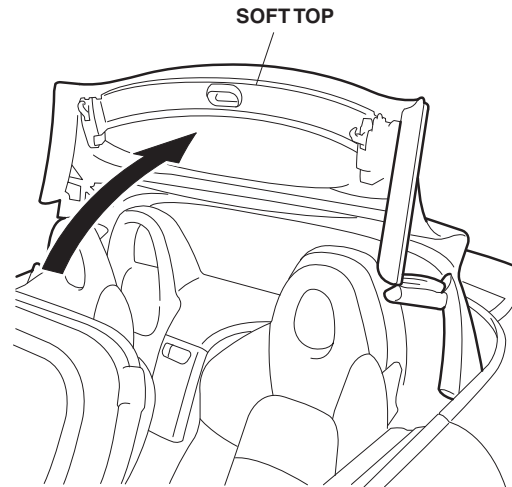

6. Raise the rear glass and pull out the rear tray. Do not damage the heater wires of the rear glass. Remove the rear tray while moving the soft top and the rear glass.

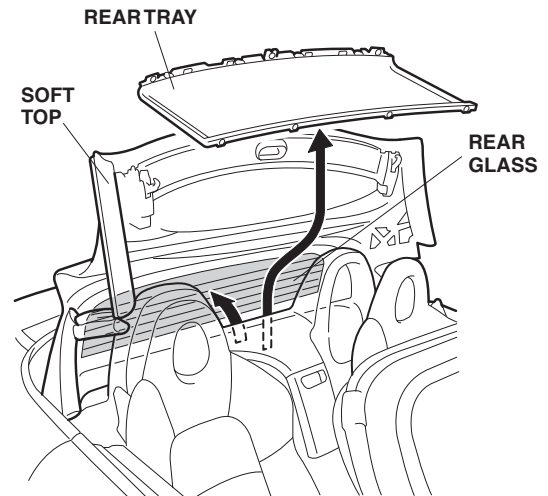

- Remove the three clips and remove the spare tire cover.

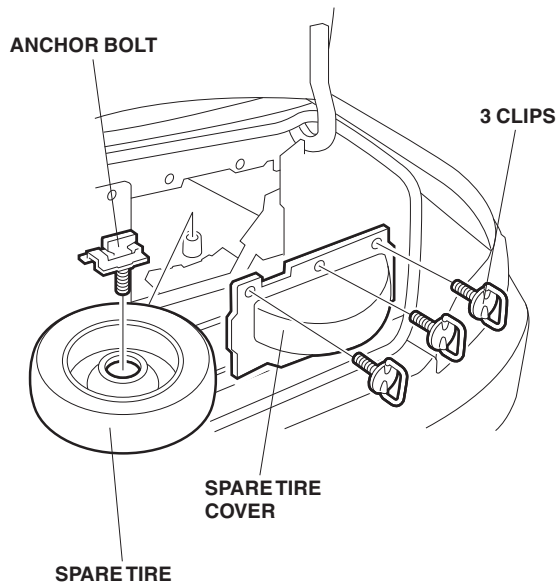

- Remove the anchor bolt and remove the spare tire. Go to step 14.

CR Model

- Disconnect the rear defroster connector, unlock the left and right front locking levers and turn the left and right handles to release the hard top from the vehicle.

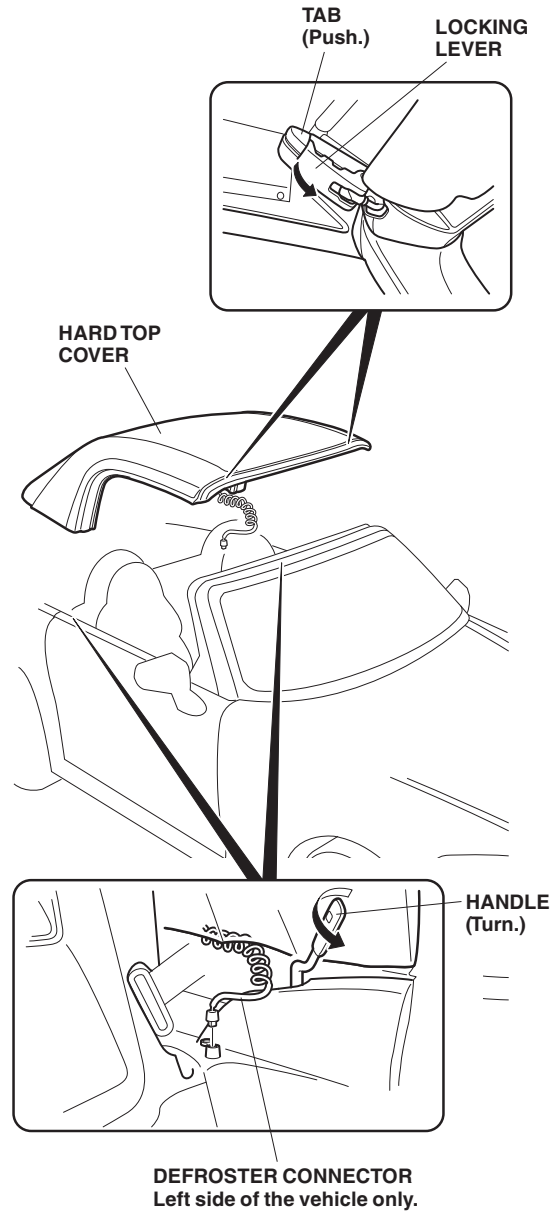

10. Loosen two bolts and disengage six retaining tabs to remove two rear side covers.

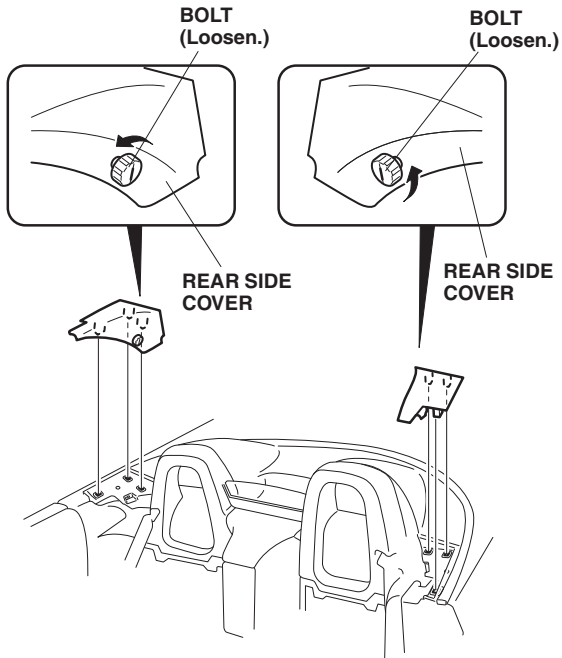

11. Disengage three retaining tabs to remove the rear cover cap.

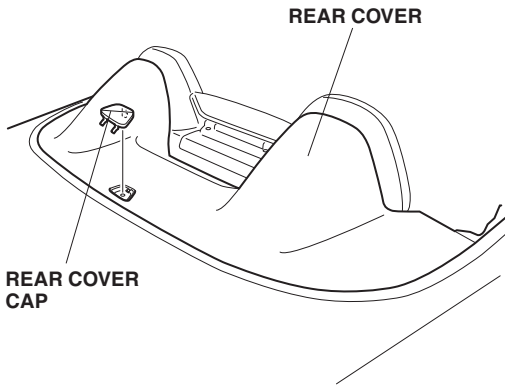

12. Remove three bolts and disengage two clips to remove the rear cover.

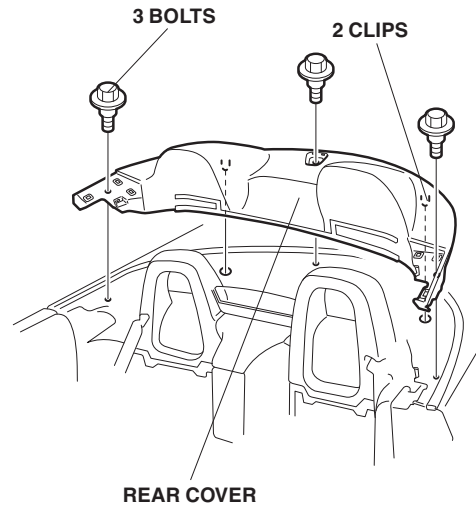

13. Remove three clips to remove the cover in the cargo area. Go to step 14.

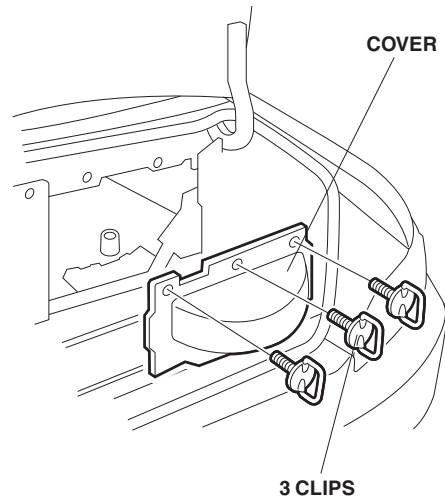

- If the vehicle is equipped with the soft top, close it completely.

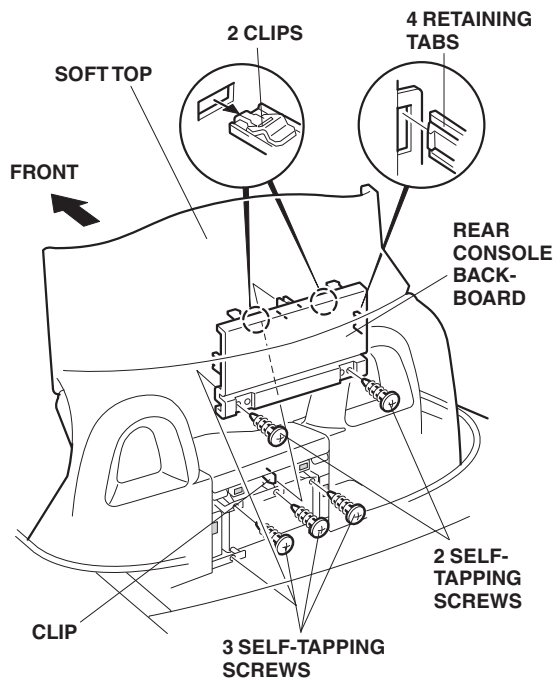

- Remove two self-tapping screws, pull the rear console backboard towards you, and remove it after disengaging three clips and four retaining tabs.
- Remove three self-tapping screws from behind the rear console backboard.

- If the vehicle is equipped with a soft top, open it completely and disconnect the negative battery cable.

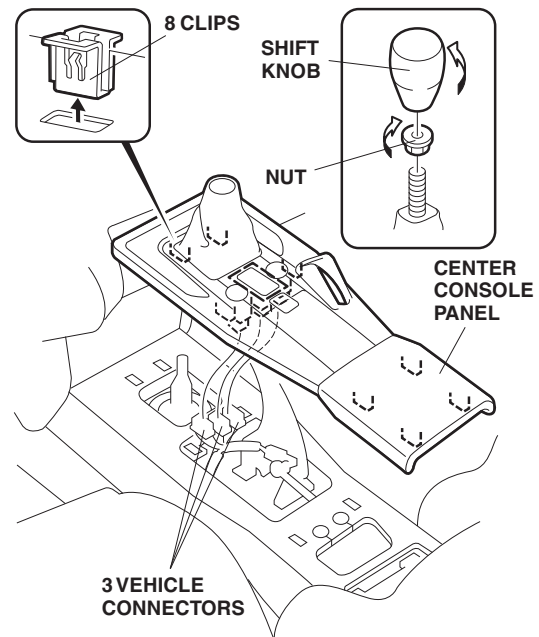

- Loosen the nut and remove the shift knob.
- Raise the center console panel and remove it after disconnecting the eight clips and three vehicle connectors.

20. Tilt the passenger seat back forward, open the two caps, remove the two screws.

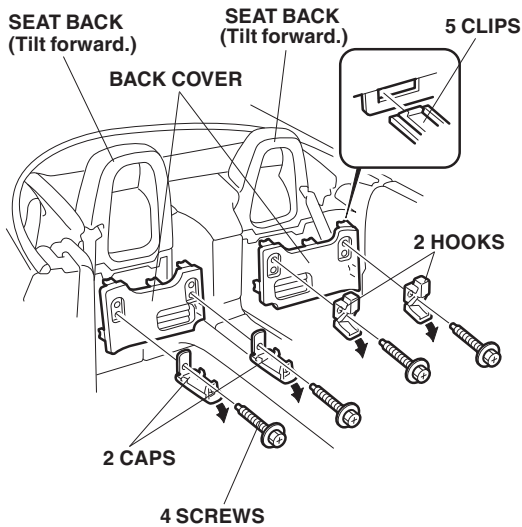

21. Remove the five clips and take off the back cover.
 22. Do steps 20 and 21 for the driver seat side.
 23. Open the rear console lid and the glove box lid. Remove five self-tapping screws and four flat-head self-tapping screws. Pull the rear console towards you and remove it after disengaging two clips and disconnecting two vehicle connectors.

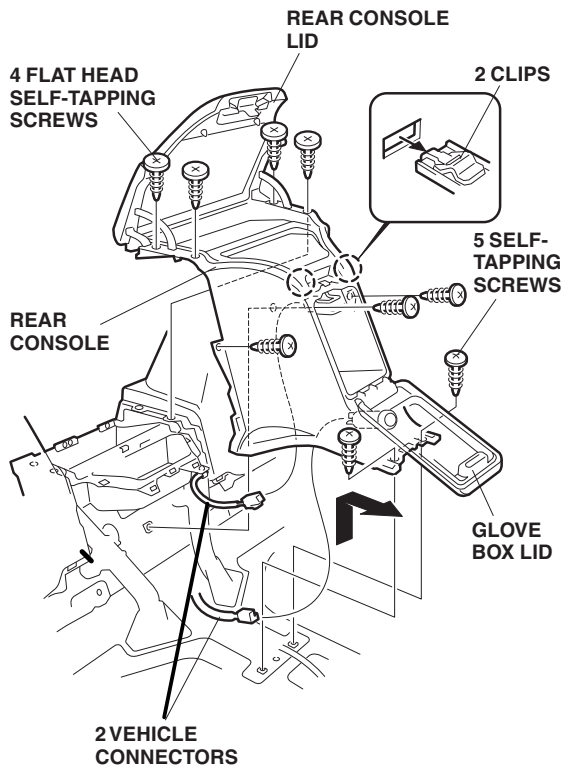

24. Using a felt-tip pen, mark the indicated positions on the rear console box.

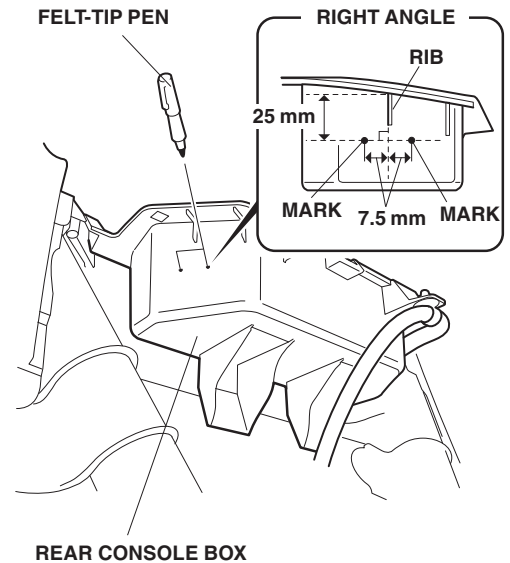

25. Using a pushpin, mark the rear console box at two locations marked in step 24.

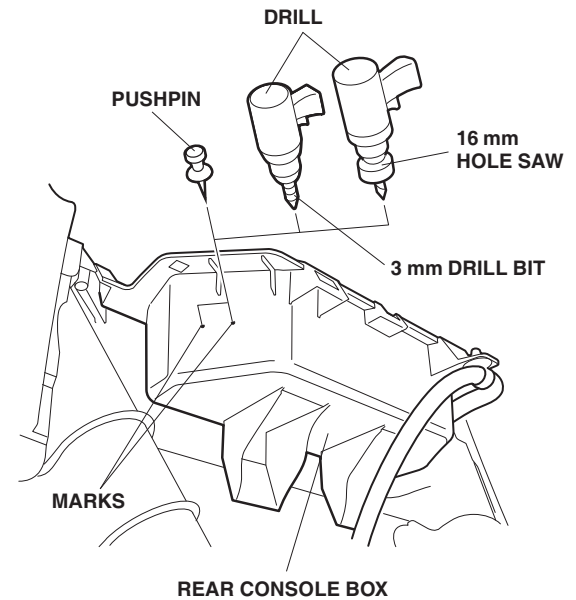

26. While wearing an eye protection, drill 3 mm holes at the two locations marked in step 25, and then enlarge the holes with 16 mm hole saw.

27. Using an utility knife, connect the two holes made in step 26 as shown to form an elongated hole. Remove any burrs.

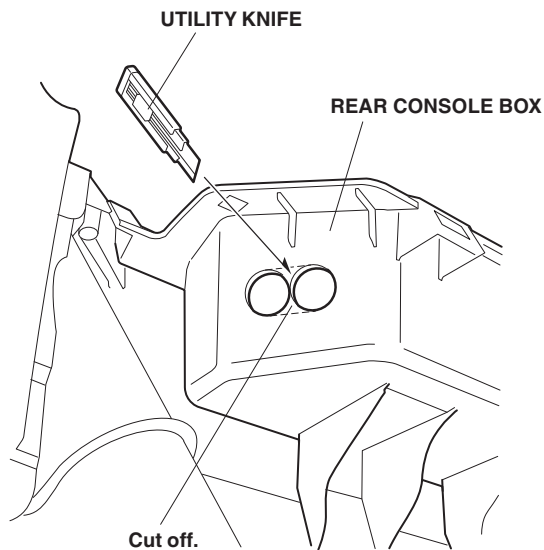

28. Attach a masking tape to the Music Link harness at the indicated position.

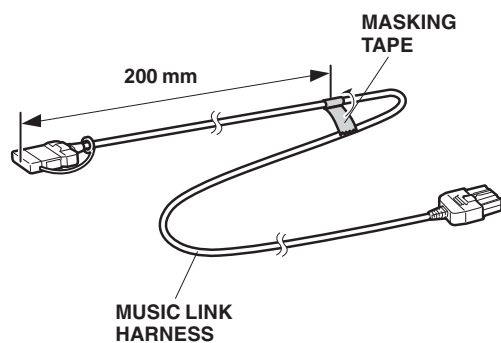

29. Connect the Music Link harness connector to the adapter unit.

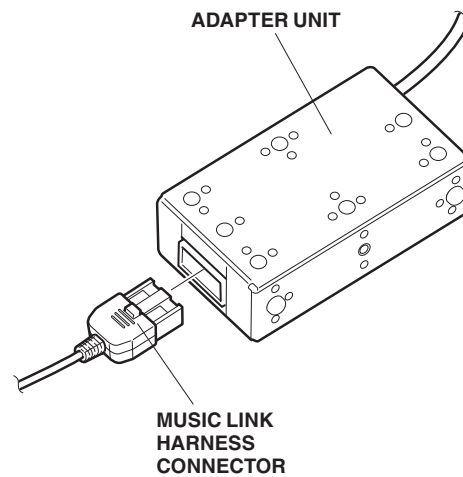

30. Route the adapter unit harness. Secure the adapter unit with a 5 x 8 mm bolt and a 5 mm plain washer to the vehicle frame. Secure with the 5 x 8 mm bolt while holding the 5 mm plain washer with your finger.

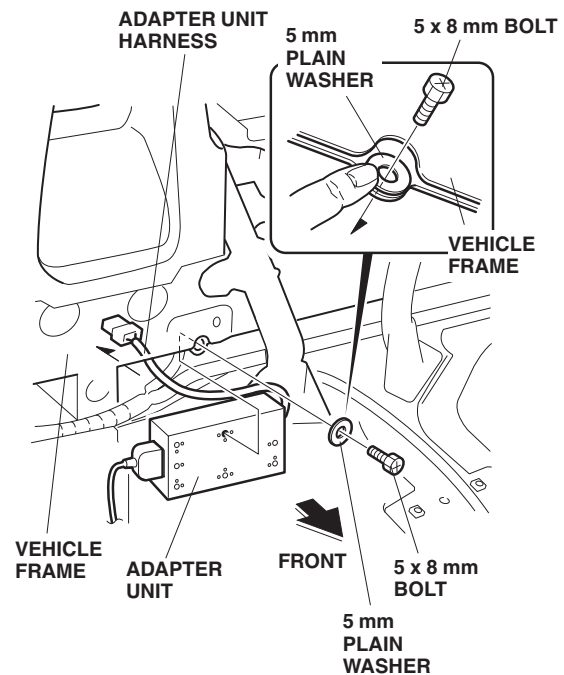

31. Route the Music Link harness as shown and loosely secure the Music Link harness to the vehicle harness with two wire ties.

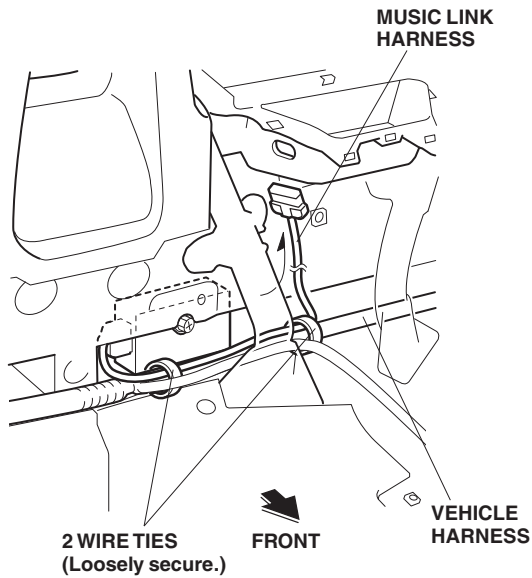

32. Remove the Music Link harness connector lid, and put the Music Link harness connector through the grommet, then put the lid through the grommet.

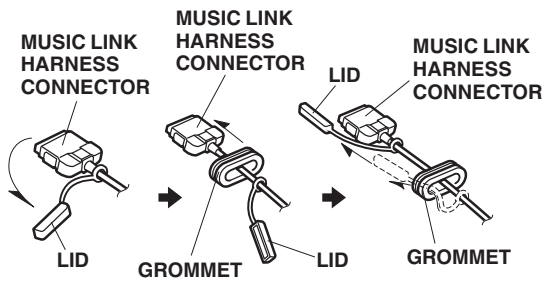

33. Route the Music Link harness connector through the hole made in the step 27, then route the lid through the hole as shown.

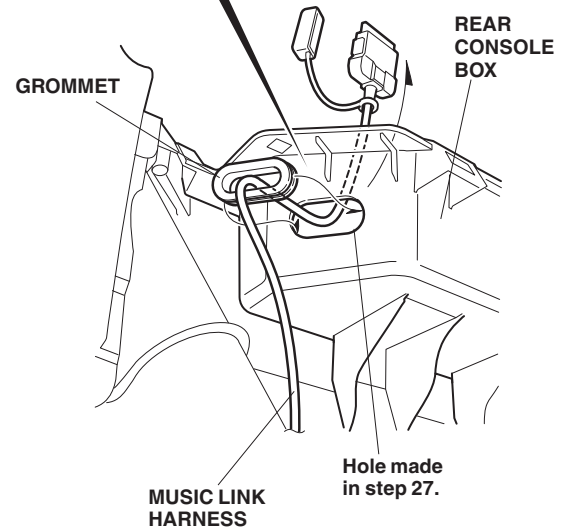
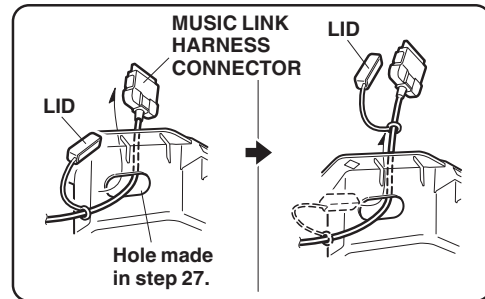

34. Reinstall the Music Link harness connector lid. Install the grommet in the rear console box.

35. Inside the trunk, release the vehicle harness from the fuel tank by cutting off the vehicle wire tie with clip. Do not damage the vehicle harness when cutting the wire tie.
36. Remove the vehicle wire tie with clip from the fuel tank.
37. Remove the tape and the dummy connector from the vehicle harness.

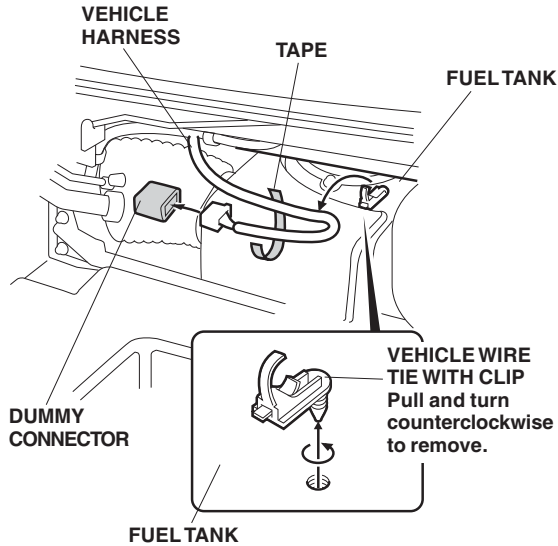

38. Route the adapter unit harness as shown and connect the adapter unit harness 14-pin connector to the vehicle harness 14-pin connector.

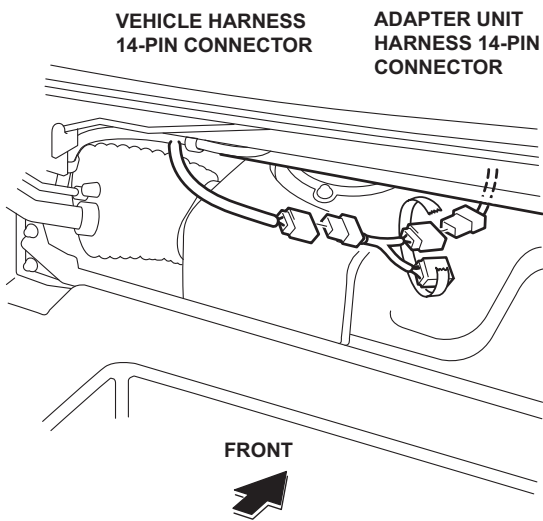

Need to add a step and illustration to show connection of the Y-cable. (See Thuan)

39. Secure the adapter unit harness to the fuel tank with two urethane tapes.

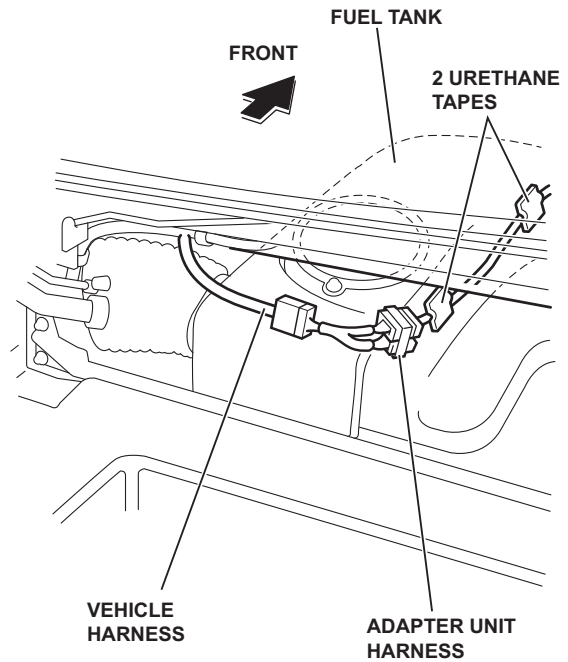

40. Bundle the excess Music Link harness and the adapter unit harness with two wire ties and secure it to the vehicle roll bar. Secure the wire tie at the tape attached in step 28.

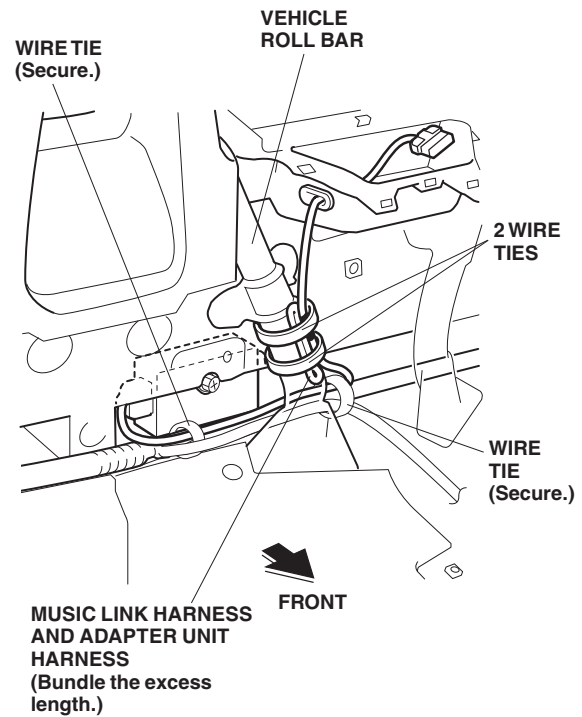

41. Secure two wire ties loosely secured in step 31.

42. Check that all wire harnesses are routed properly and all connectors are plugged in.
43. Reconnect the negative cable to the battery.
44. Reinstall all removed parts.
45. Enter the customer's radio anti-theft code, and reset the radio station presets.
46. **Turn the radio unit ON. Set mode to Honda Music Link by pressing "CD" until display "CDC" or "CD4" is shown on the radio display. Check that the mode changes to the CD changer mode properly ("CDC" or "CD4" is shown on the radio display).**